

Open Data Management: Training and Support from the EPFL Library

Chiara Gabella
Head of RDM team

EPFL Library mission

We provide

EPFL's student, teaching and research communities with support, advice and expertise in scientific information.

We facilitate

the creation, dissemination, promotion and preservation of EPFL's academic and scientific output.



Academic and Research Support

Academic and Research Support

Guilaine Baud-Vittoz

Training

– **Reinaldo Saavedra**

formations.bib@epfl.ch

- Coordination of the Library's training offer
- Information and data literacies
- Specialized training for students, PhD students and researchers
- Individual or group sessions

Scientific Publication and OA

– **Lorenza Salvatori**

publishsupport@epfl.ch

- Consulting, training and expertise
- Copyright and publication licenses
- Open Access, including financial support
- R&P and OA contracts and licenses

Research Data Management and

ORD – **Chiara Gabella**

researchdata@epfl.ch

- Consulting, training and expertise
- Best practices and data management (FAIR principles, DMP, data licensing)
- Support for Open Research Data (ORD)
- EPFL Data Champions



Chiara Gabella
Head of team,
PhD in Biophysics
EPFL Library

chiara.gabella@epfl.ch



Alain Borel
RDM Specialist
PhD in Chemistry & Librarian
EPFL Library

alain.borel@epfl.ch



Francesco Varrato
RDM Specialist
PhD in Computational Physics
EPFL Library

francesco.varrato@epfl.ch



Angela Montano
RDM Training Specialist
MsC in Human & Social Sciences
EPFL Library

angela.montanogarcia@epfl.ch

researchdata@epfl.ch



Open Position: [RDM Specialist](#)

EPFL's main collaborations

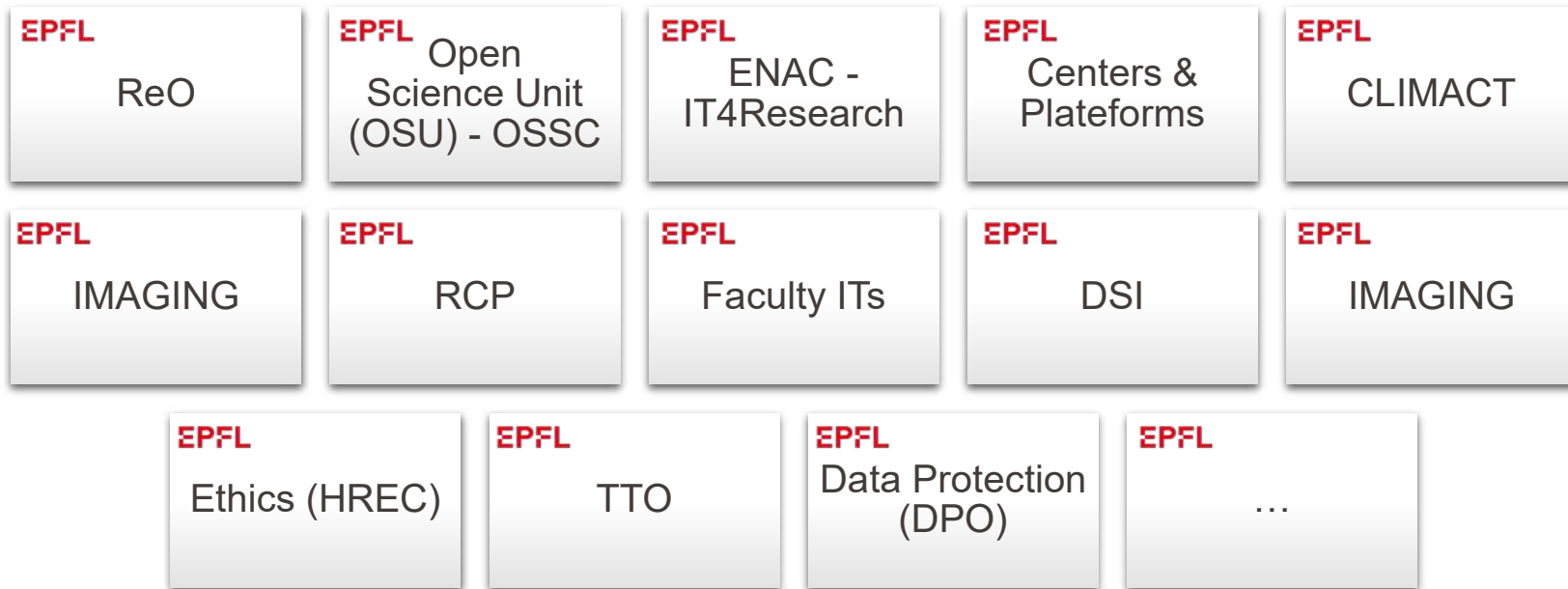

The RDM ecosystem (Swiss and beyond)

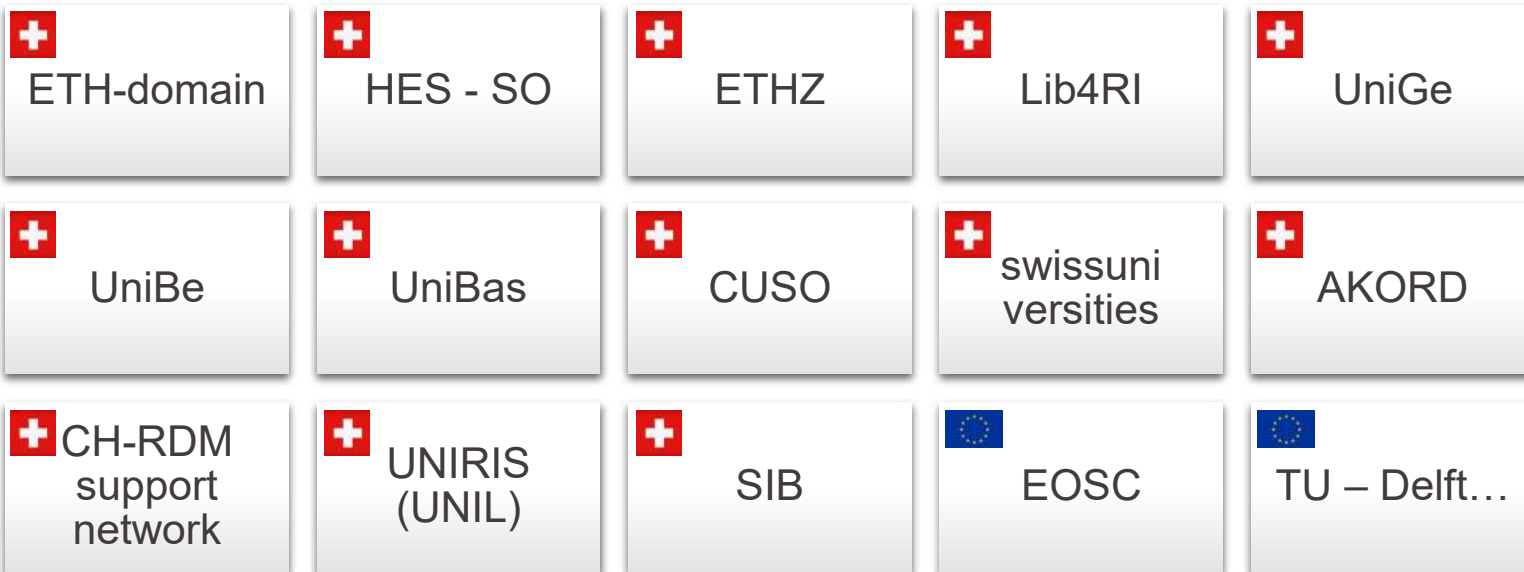

Research data management

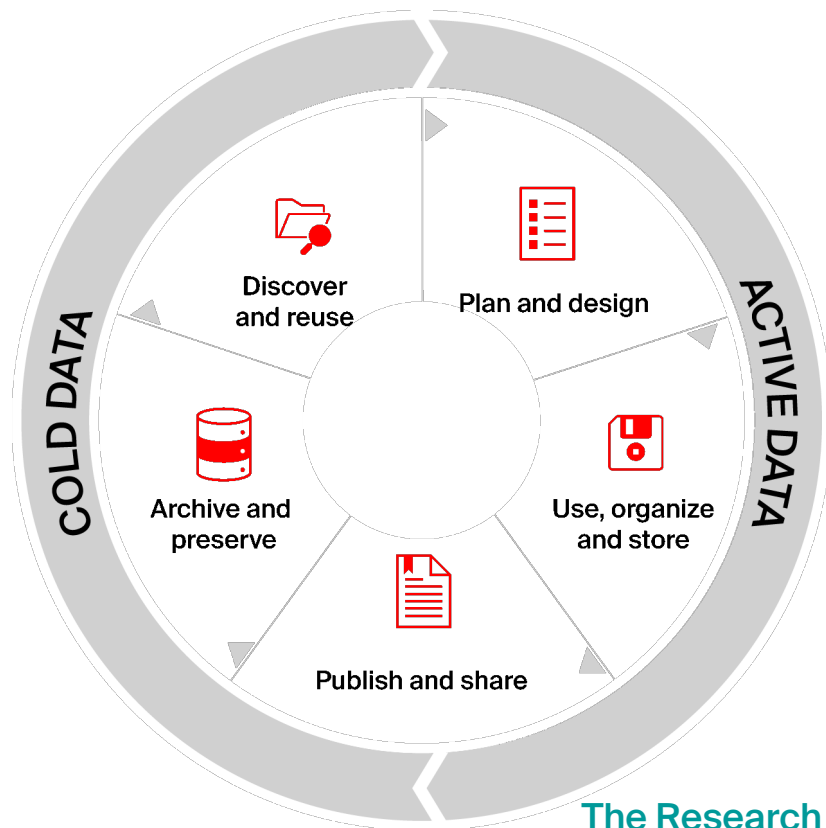

The Research Data Life Cycle



RDM PLANNING

- RDM Strategy
- DMP review
- Funders requirements
- Templates creation / maintenance

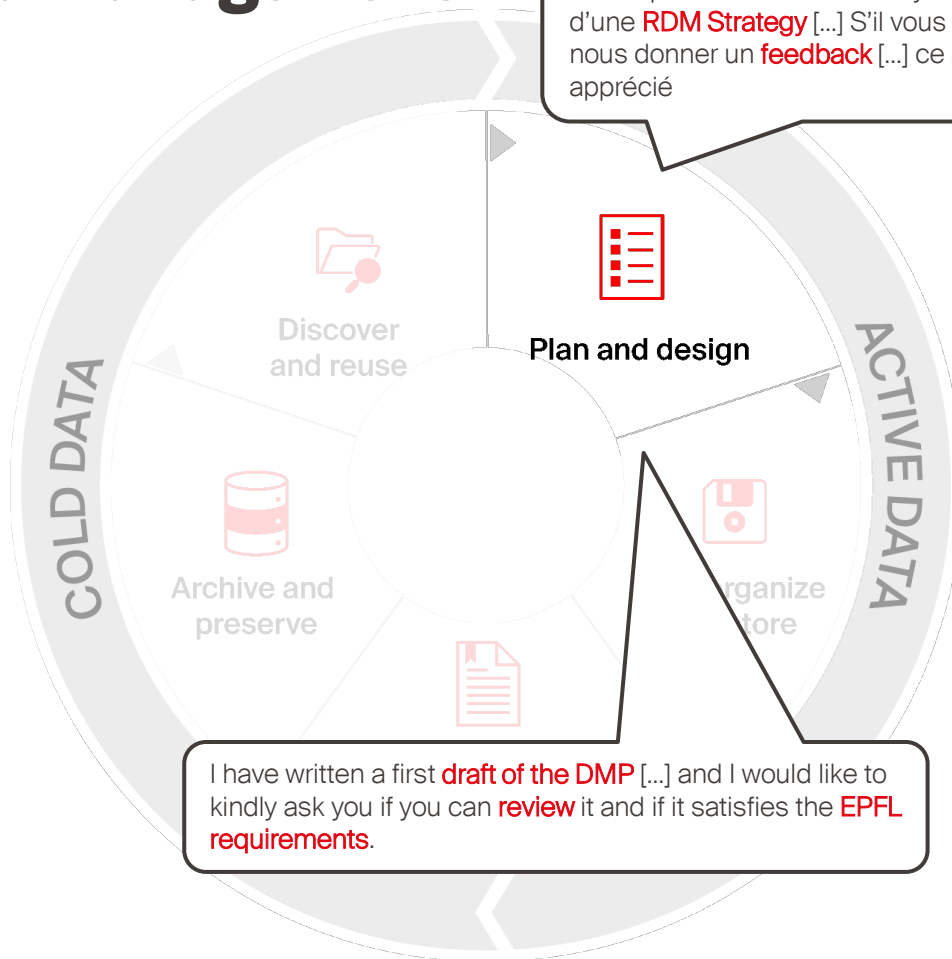

COLLECTION / CODING

- Files/folders structuring
- Storage/backup solutions
- Naming convention
- Metadata

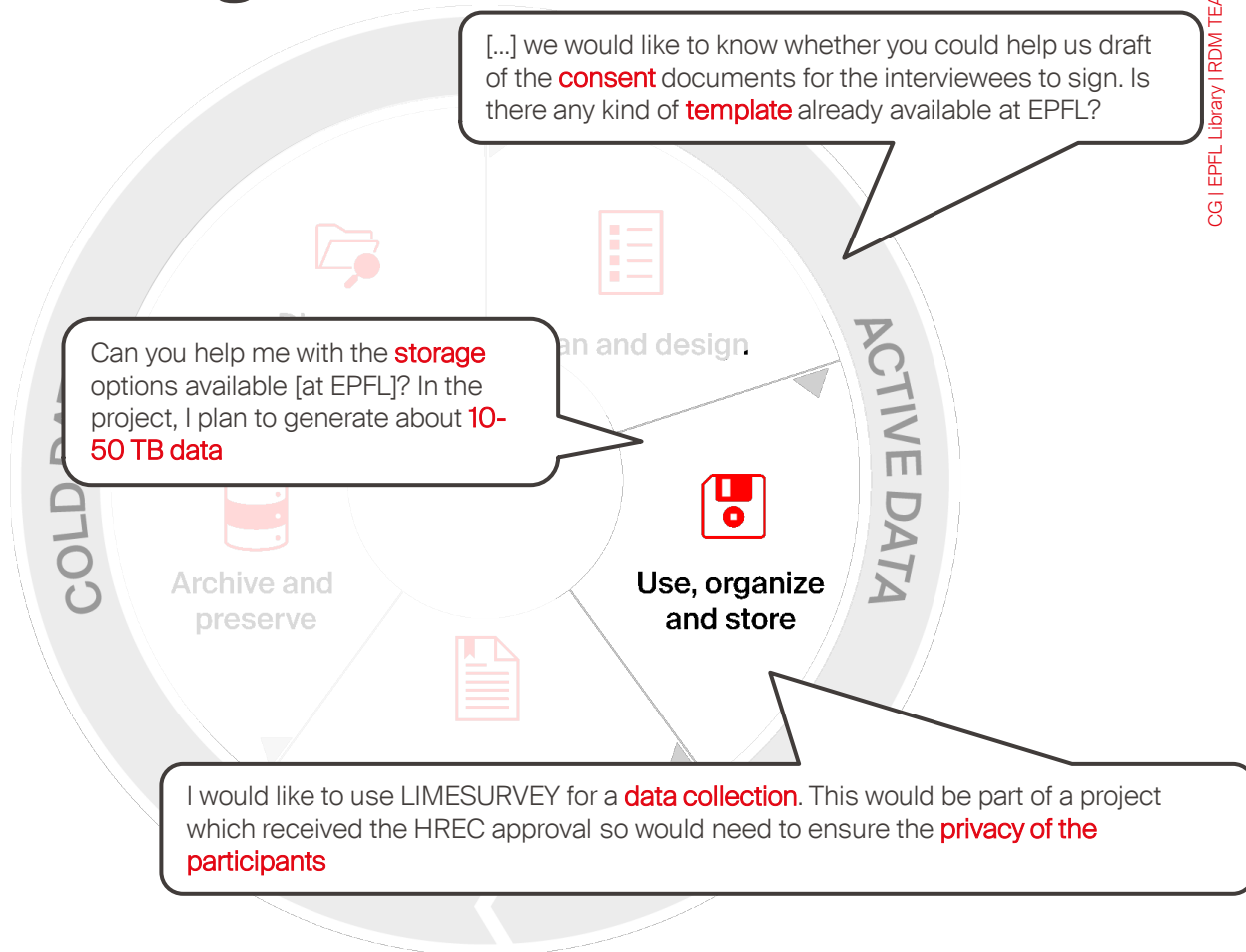

ANALYSIS / PROCESSING

- ELN / LIMS
- Sharing solutions
- Tools exploration
- Documentation

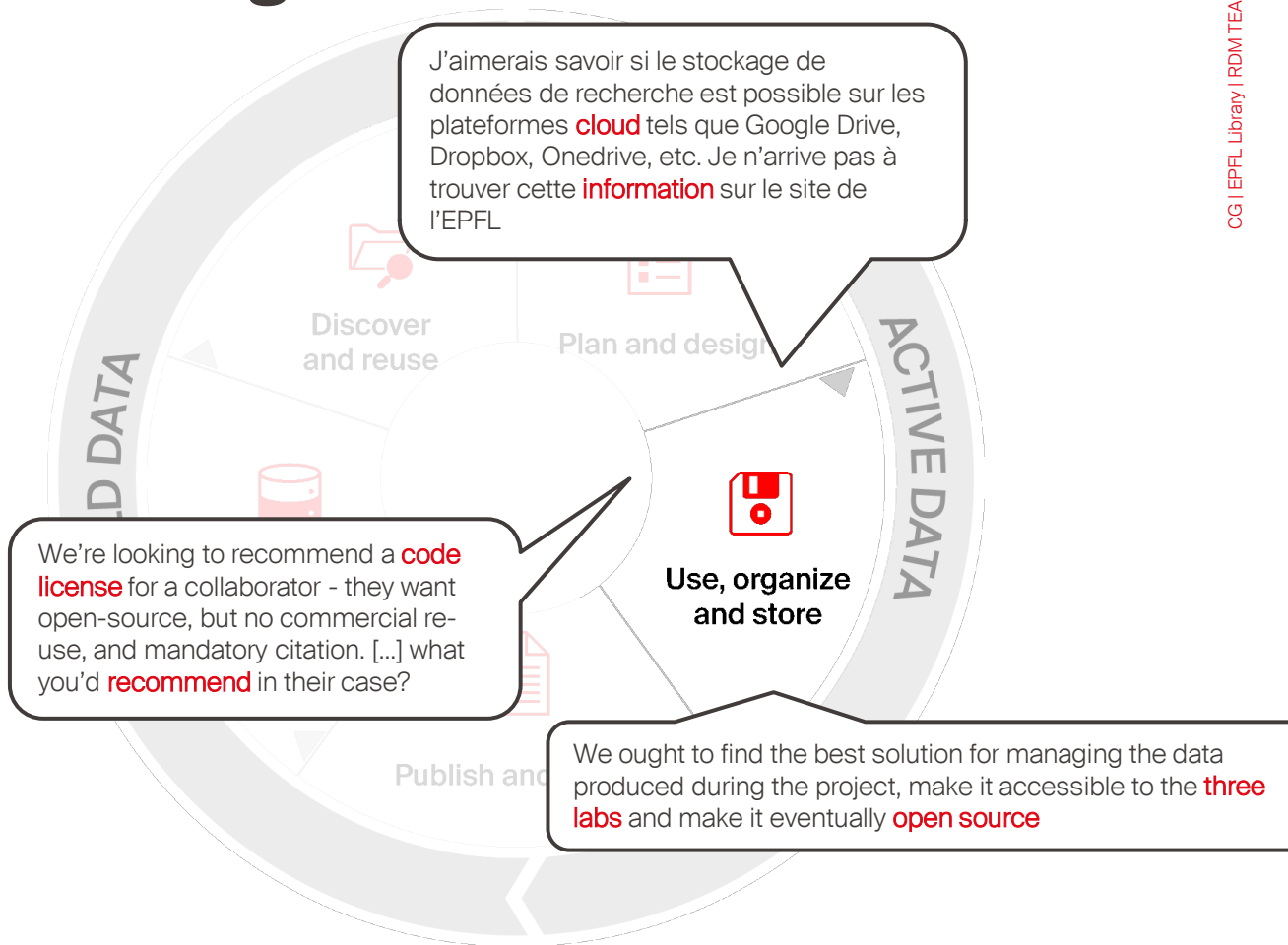

Data CURATION

- Anonymization
- Formats
- Cleaning

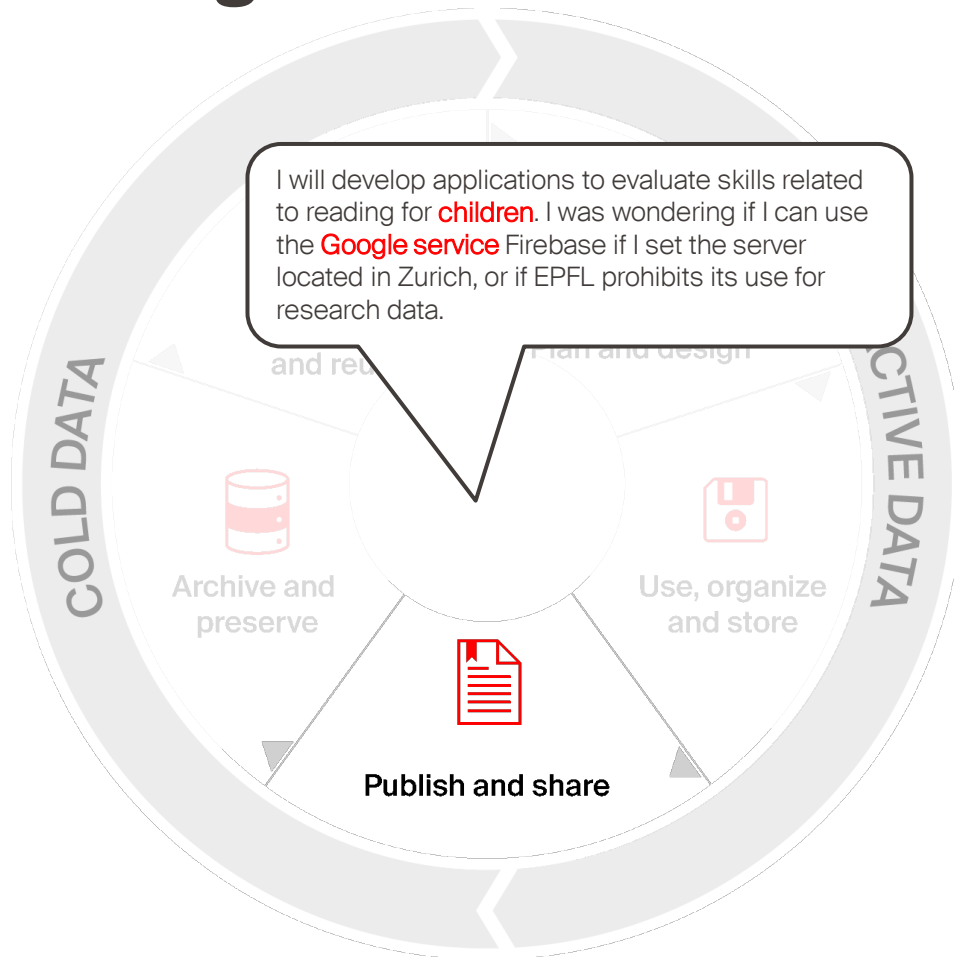

PUBLICATION / ARCHIVING

- Licensing
- Data repositories
- Data journals
- Deposition support
- EPFL-most used repositories
- Zenodo EPFL Community
- ACOUA (ACademic OUtput Archive)

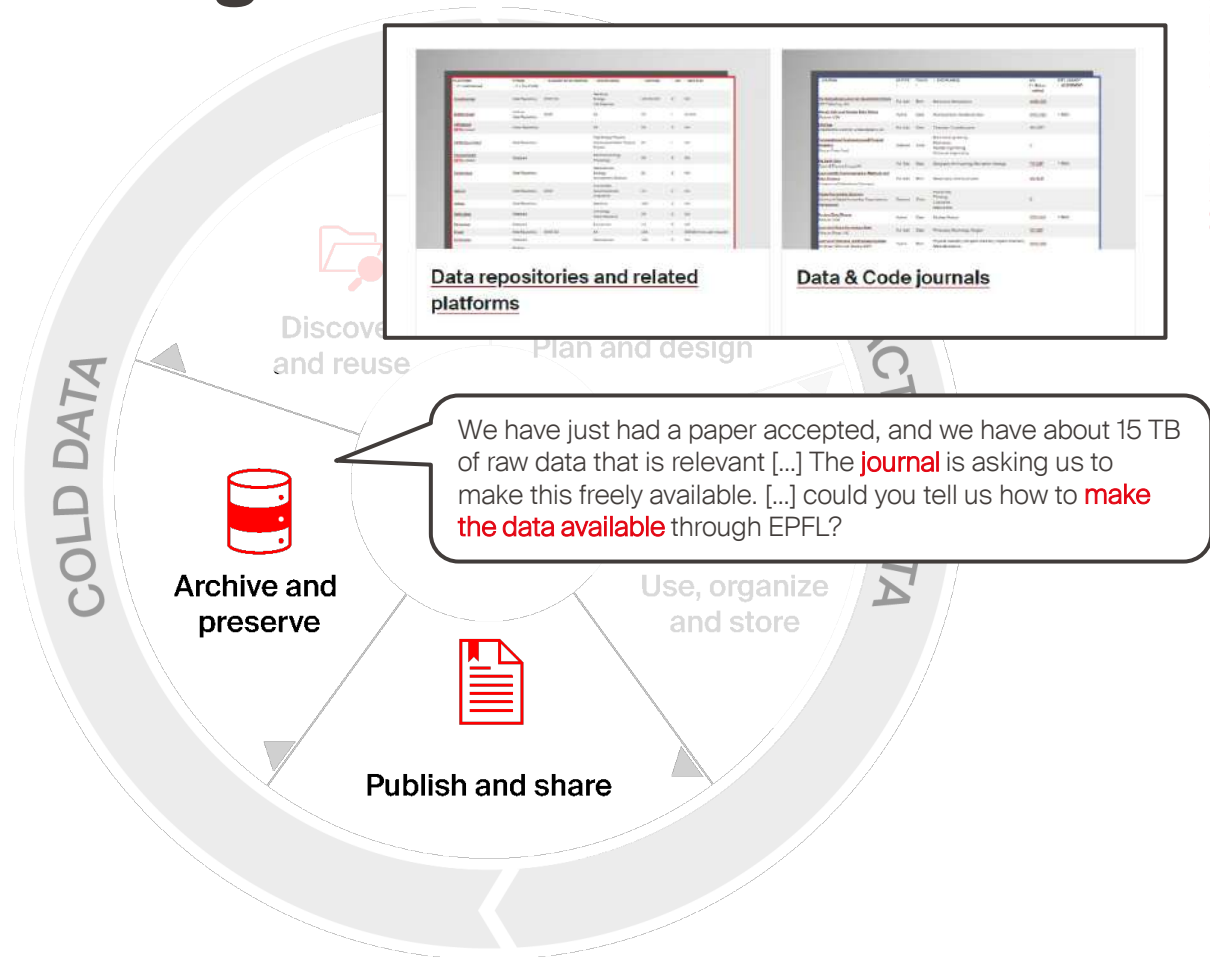

DISCOVERY / REUSE

- Licenses & negotiation
- Text & data mining
- Content searching
- Citations

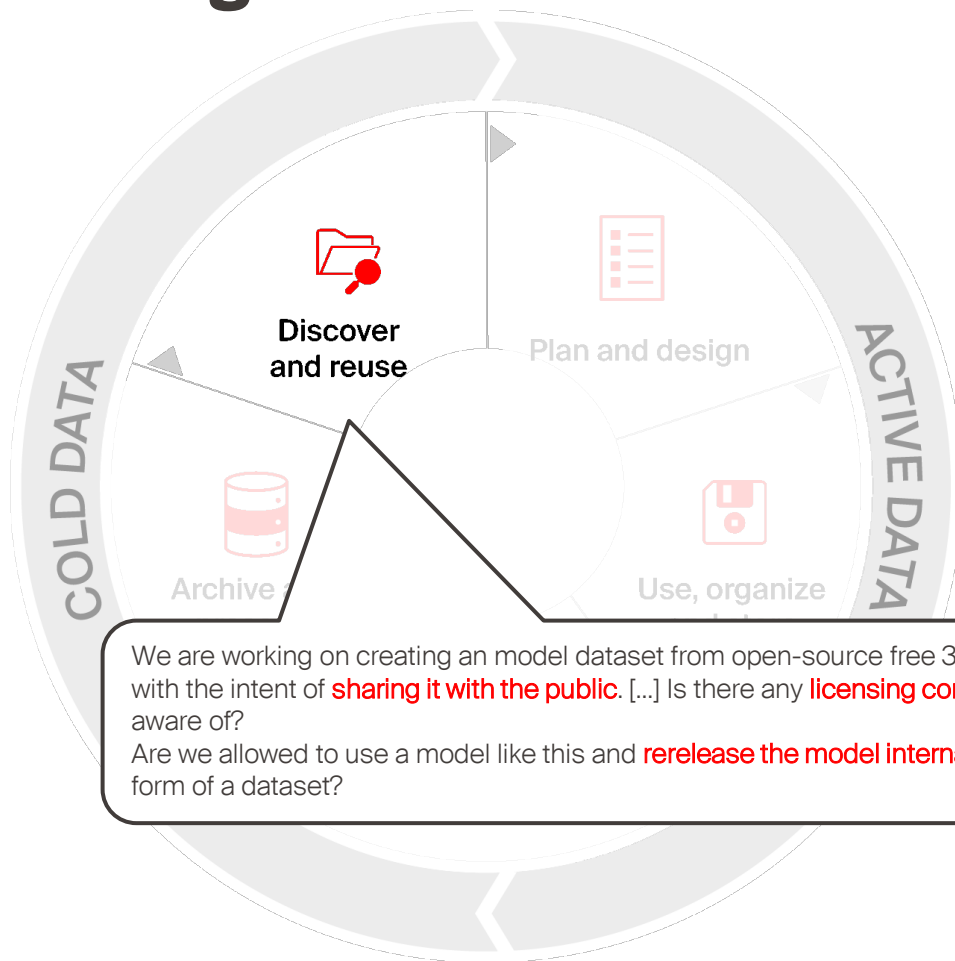

Daily support to EPFL researchers *on demand*



Includes all DMP-related services:

- ✓ Providing EPFL researchers with DMP templates and support on the various funding agencies (SNSF, ERC, Horizon EU,...)
- ✓ Tools production: RDM cost calculator, EPFL DMP template...
- ✓ Review for researchers and for funders (EPFL as funding agency)
- ✓ Offering training on DMP writing and best practices
- ✓ RDM strategy
- ✓ In-depth reflections on DMP tools (assessments, guidelines, maDMP...)

Dataset curation on Zenodo



Curation policy for the [Zenodo | EPFL Community](#):

- ✓ Curation of EPFL dataset on RDM best practices
- ✓ Policy compliant datasets join EPFL Community on Zenodo
- ✓ Visibility on Infoscience: notification on IS is automatically attributed
- ✓ Long-term preservation: data archived in ACOUA

75 datasets in 2023, total 358

DESCRIPTION

The aim of this EPFL Community on Zenodo is to strengthen the visibility and re-usability of the datasets produced by EPFL researchers, and to facilitate the dissemination of information (links between publications and data; potential re-use by other researchers; reporting for scientific grants; etc.).

For support with your dataset submission and curation, or for any questions about this community, please contact the RDM team of EPFL Library at researchdata@epfl.ch.

CURATION POLICY

The **MUST** criteria are required in order to accept a submission to the EPFL community.

MUST



- Regular offer: 4 training on RDM best practices, 1x /semester
 - ✓ 2 hours training (live & zoom), with hands-on individual work
- Credited course:
 - ✓ EDCH credited course on RDM (3 days training, final report and evaluation)
 - ✓ Prep. of “Research skills in the Open Science Era” (incl. RDM/ORD) for EDCE
 - ✓ (Others to come)
- Individual training / workshop *ad-hoc* & support 1:1 on demand
- Participations in external courses / conferences (e.g. CUSO)

Module 1



ABC of Research Data Management

Main topics:

FAIR principles, ORD, OS, RDLC, EPFL services

- Identify F.A.I.R. data practices;
- Recognize the right EPFL services that meet your RDM needs.



online



next semester

Module 2



Data Management Planning & Funding

Main topics:

DMP, RDM Strategy, funders, costs, templates

- Implement your own DMP;
- Assess the compliance of your DMP with funders' requirements (ex. SNSF, ERC or EPFL)



on campus



next semester

Training – regular offer

Module 3



Data Organization & Storage Solutions

Main topics:

Metadata, naming, formats, backup VS archive

- Distinguish between storage, backup, and archiving solutions.
- Test your file naming convention against good practices.



online



22 May 2024 14:00 – 15:30

Module 4



Data & Code Publication

Main topics:

Zenodo, Github connection, data journals, licensing, anonymization

- Choose the right repository for your code/data;
- Publish your code/data in the EPFL Zenodo community.



on campus



20 June 2024 14:00 – 15:30

Current project : ETH-Domain ORD Program (M3)

Develop Open Educational Resources for ORD across ETH-Domain



Make RDM / ORD trainings from the various institutes of the ETH Domain (libraries, competence centers, laboratories, central services, etc.) available to the entire ETH public and open to all (OER)

1st deliverables: end 2024

E-Learning course



Image: Freepik

OER modules / catalog



Image: Freepik

<https://open-research-data-portal.ch/>

- library@epfl.ch
- www.epfl.ch/campus/library/
- @EPFLlibrary



<https://www.epfl.ch/campus/library/services-researchers>

- researchdata@epfl.ch
- publishsupport@epfl.ch
- formations.bib@epfl.ch
- infoscience@epfl.ch
- acoua@epfl.ch

